

REV.	DATE	DESCRIPTION	DARWN BY	CHECKED BY
0	2021-10-26	INITIAL RELEASE - eCommerce	VK	KW

This Handrail Fitting meets the requirements of the National Building Code of Canada 2015, Div B, Section 3.4.6.5.
Allowable loads are for distance between fittings of up to 1.5m.

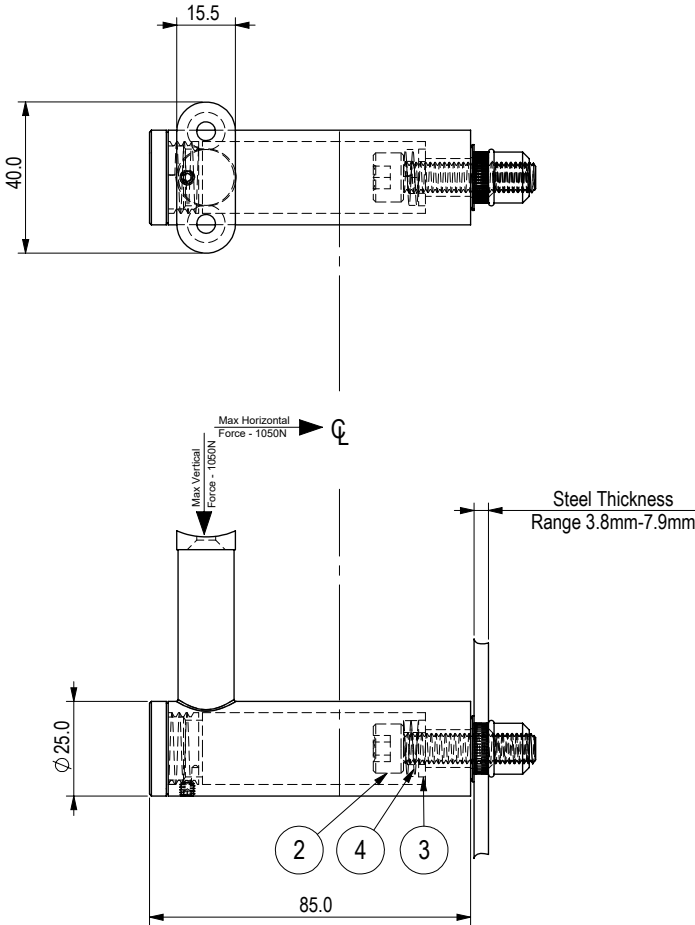

ITEM	PART	DESCRIPTION	MATERIAL	FINISH	QTY.
1	BA02-SA02.1	HANDRAIL FITTING - POST MOUNTED - CURVED SADDLE	Gd 316 SS	SATIN	1
2	SHCS - M8	M8 SOCKET HEAD CAP SCREW M8 X 35mm LG.	A2 - 70	EX WORKS	1
3	FW-M8	M8 FLAT WASHER	A2-70	EX WORKS	1
4	W M8	LOCK WASHER M8	A2-70	EX WORKS	1
5	NU M8-8.9	NUTSERT M8-8.9	STEEL 1010/1008	EX WORKS	1

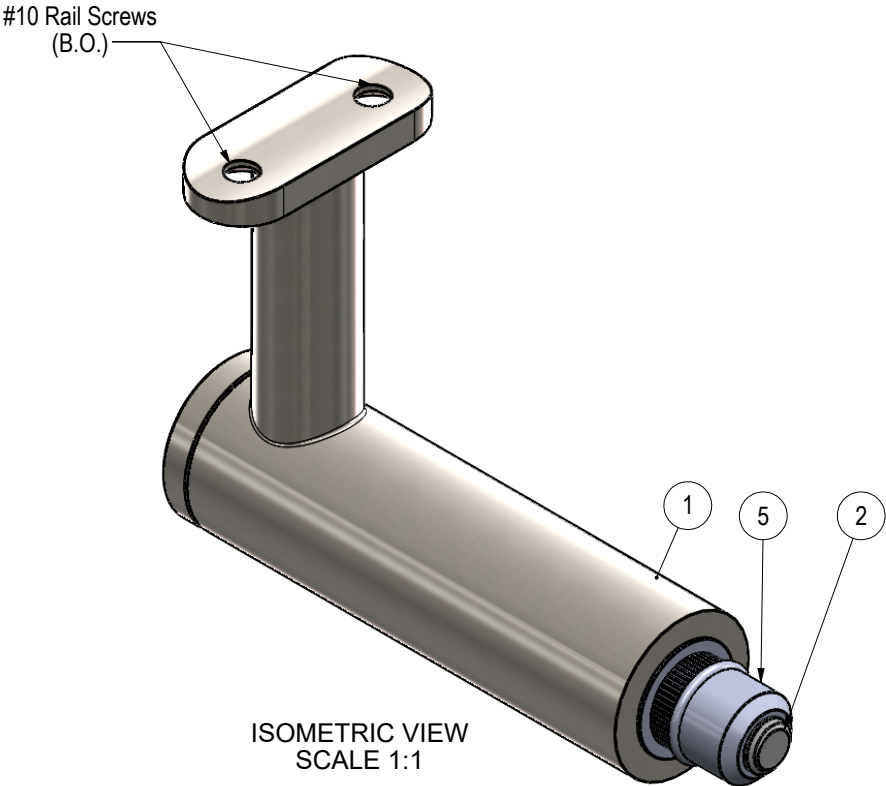

General Tolerances (ISO 8062-CT6). (mm) Unless Specified Otherwise

NOM. DIMENSION	0 TO 10	10 TO 16	16 TO 25	25 TO 40	40 TO 63	63 TO 100	100 TO 160	160 TO 250	250 TO 400
TOLERANCE	±0.26	±0.27	±0.29	±0.32	±0.35	±0.39	±0.44	±0.50	±0.55
ANGLE TOLERANCE: ±0.5°									

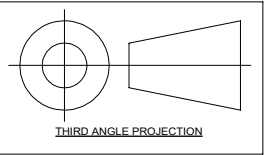

UNIT 105-8218 NORTH FRASER WAY, BURNABY, BC, V3N 0E9
TEL (604) 231 5892
WWW.STELLAGLASSHARDWARE.COM

ASSEMBLY DRAWING - HANDRAIL FITTING - BA3820S04S
STELLA GLASS HARDWARE - eCommerce

SCALE
1:2
SKETCH NO.
BA3820S04S

- NOTES:
- All dimensions are in millimeters unless otherwise specified.
 - Loctite Type 243 all threads during site installation (B.O.)
(To increase curing speed, please apply activator 7649)