

REV.	DATE	DESCRIPTION	DARWN BY	CHECKED BY
0	2021-10-26	INITIAL RELEASE - eCOMMERCE	VK	KW

ITEM	PART	DESCRIPTION	MATERIAL	FINISH	QTY.
1	BA503S05D	HANDRAIL FITTING-WALL MOUNTED-CURVED SADDLE	DUPLEX 2205 SS	SATIN	1

This Handrail Fitting meets the requirements of the National Building Code of Canada 2015, Div B, Section 3.4.6.5. Allowable loads are for distance between fittings of up to 1.5m.

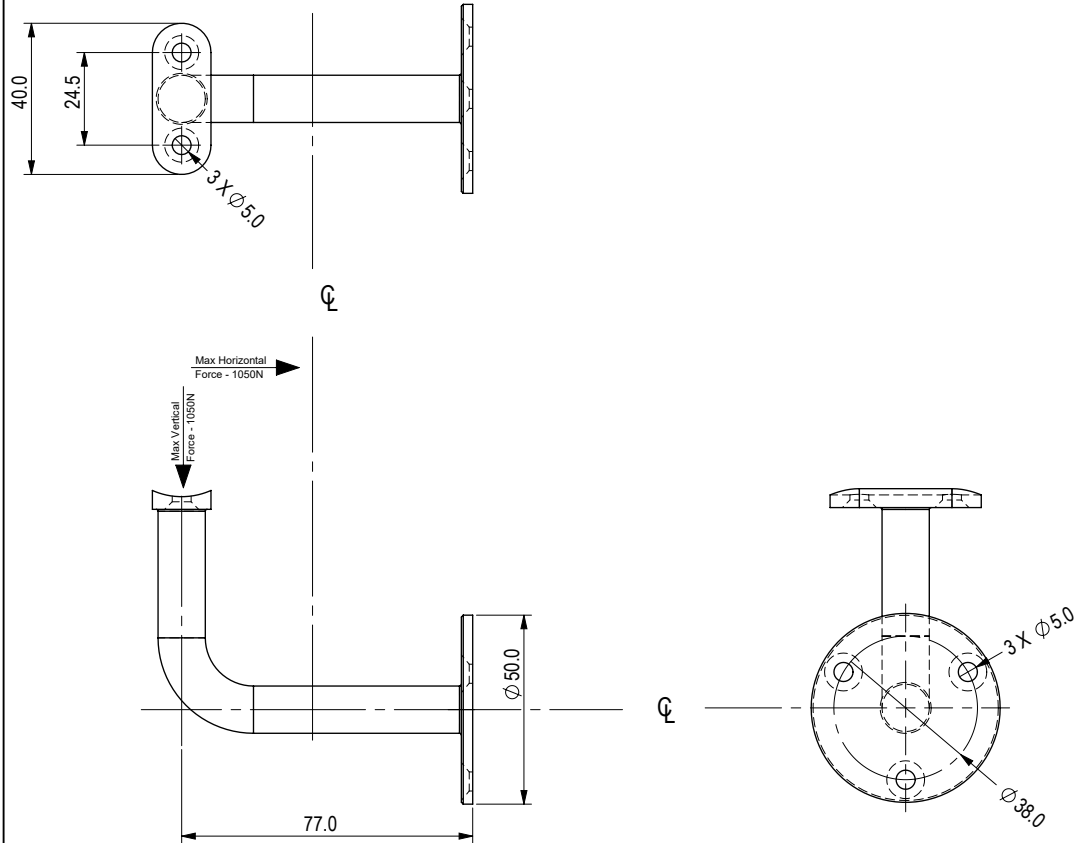

#10 Rail Screws (B.O.)

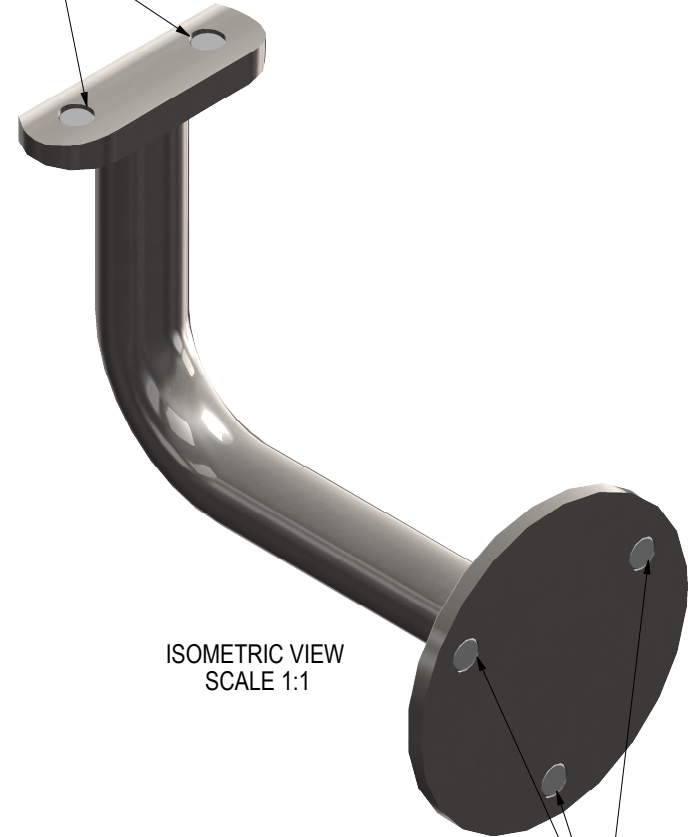

ISOMETRIC VIEW  
SCALE 1:1

#10 Rail Screws (B.O.)

**NOTES:**

- All dimensions are in millimeters unless otherwise specified.
- #10 Screws by others.

General Tolerances (ISO 8062-CT6). (mm) Unless Specified Otherwise									
NOM. DIMENSION	0 TO 10	10 TO 16	16 TO 25	25 TO 40	40 TO 63	63 TO 100	100 TO 160	160 TO 250	250 TO 400
TOLERANCE	±0.26	±0.27	±0.29	±0.32	±0.35	±0.39	±0.44	±0.50	±0.55
ANGLE TOLERANCE: ±0.5°									

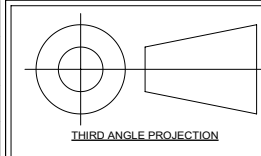

**ASSEMBLY DRAWING - HANDRAIL FITTING - BA503S05D**  
STELLA GLASS HARDWARE - eCOMMERCE

SCALE	1:1
SKETCH NO.	
	BA503S05D



UNIT 105-8218 NORTH FRASER WAY, BURNABY, BC, V3N 0E9  
TEL (604) 231 5892  
[WWW.STELLAGLASSHARDWARE.COM](http://WWW.STELLAGLASSHARDWARE.COM)