

| REV. | DATE | DESCRIPTION | DARWN BY | CHECKED BY |
|------|------------|-----------------------------|----------|------------|
| 0 | 2021-11-09 | INITIAL RELEASE - eCOMMERCE | VK | KW |

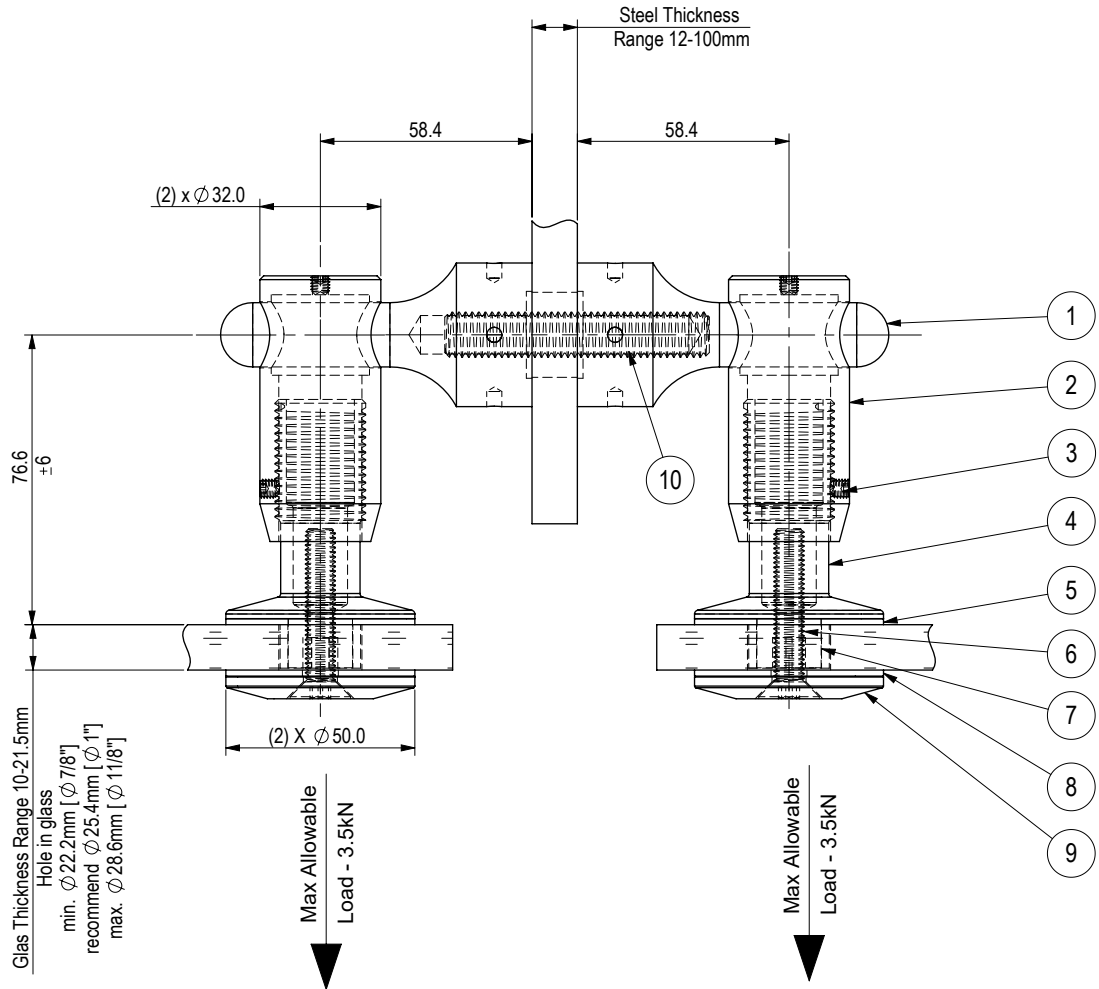

Glas Thickness Range 10-21.5mm
 Hole in glass
 min. Ø 22.2mm [Ø 7/8"]
 recommend Ø 25.4mm [Ø 1"]
 max. Ø 28.6mm [Ø 1 1/8"]

| ITEM | PART | DESCRIPTION | MATERIAL | FINISH | QTY. |
|------|------------|--|------------------|----------|------|
| 1 | DP2-P01 | PIN CONNECTOR | Gd 316 SS | MACHINED | 2 |
| 2 | DP9-P04b | DOC - BACK END (FEMALE) | Gd 316 SS | MACHINED | 2 |
| 3 | SSS M5x5 | SET SCREW-HEX SOCKET- M5 X 5 | A2-70 | EX WORKS | 4 |
| 4 | DP9-P04a | ADJUSTABLE DOC BACK (MALE) | Gd 316 SS | MACHINED | 2 |
| 5 | NB4-P14 | GASKET, 1 15/16" OD x 11/16" ID x 1/16" THK. | CG608-NYLON-GREY | EX WORKS | 2 |
| 6 | FHCS M8x45 | FLAT HEAD SOCKET CAP SCREW, M8 X 45 Lg. | A2-70 | EX WORKS | 2 |
| 7 | NB4-P05b | FERRULE OD-21.3mm (for Glass Only) | NYLON BLACK | MACHINED | 2 |
| 8 | NB1-P03 | GASKET-1 15/16" OD x 5/16" ID x 1/16"THK | CG608-FIBER-GREY | EX WORKS | 2 |
| 9 | NB1-P01 | Dia 50 FRONT PLATE | Gd 316 SS | MACHINED | 2 |
| 10 | St M12 | STUD, M12 (LENGTH VARIES) | A2-70 | EX WORKS | 1 |

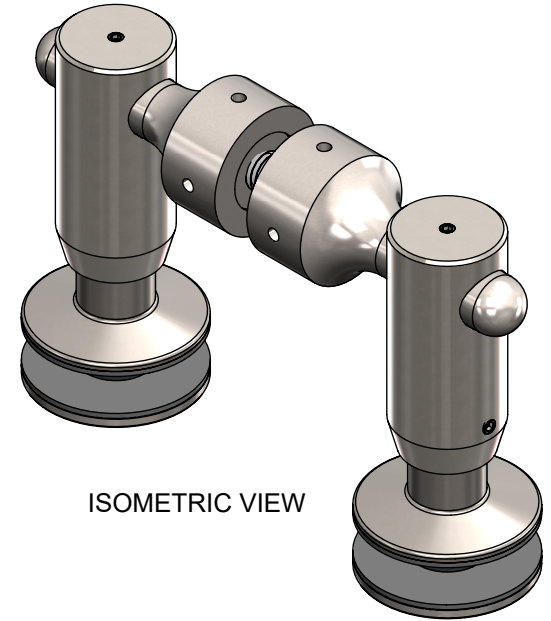

ISOMETRIC VIEW

| General Tolerances (ISO 8062-CT6). (mm) Unless Specified Otherwise | | | | | | | | | |
|--|---------|----------|----------|----------|----------|-----------|------------|------------|------------|
| NOM. DIMENSION | 0 TO 10 | 10 TO 16 | 16 TO 25 | 25 TO 40 | 40 TO 63 | 63 TO 100 | 100 TO 160 | 160 TO 250 | 250 TO 400 |
| TOLERANCE | ±0.26 | ±0.27 | ±0.29 | ±0.32 | ±0.35 | ±0.39 | ±0.44 | ±0.50 | ±0.55 |
| ANGLE TOLERANCE: ±0.5° | | | | | | | | | |

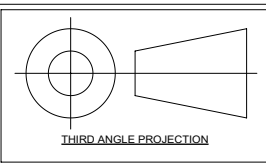

- NOTES:**
- All dimensions are in millimeters unless otherwise specified.
 - Loctite Type 243 all threads during site installation (B.O.)
(To increase curing speed, please apply activator 7649)

ASSEMBLY DRAWING - DOC & PIN - DP5052T0
STELLA GLASS HARDWARE - eCOMMERCE

| | |
|------------|-----|
| SCALE | 1:2 |
| SKETCH NO. | |
| DP5052T0 | |



UNIT 105-8218 NORTH FRASER WAY, BURNABY, BC, V3N 0E9
 TEL (604) 231 5892
 WWW.STELLAGLASSHARDWARE.COM